

# JET AERATOR

4 KW ( 5.5 HP )

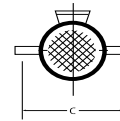
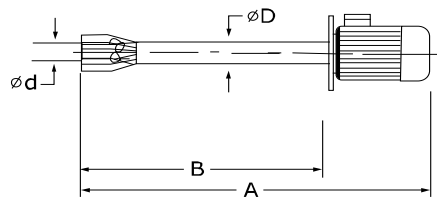
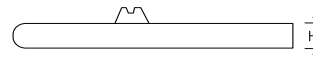
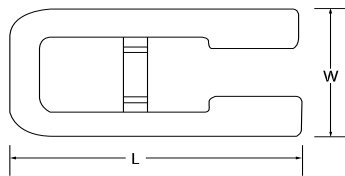
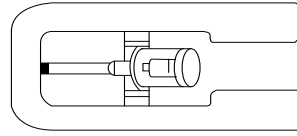
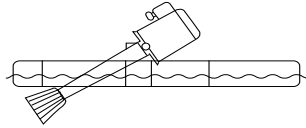

## DIMENSION

MODEL	KW	HP	A	B	C	L	W	H
JET-A055-3P	4	5.5	1,325	1,000	370	1,500	750	200

## SPECIFICATION FLOATED TYPE JET AERATOR

Motor	"ABB" or equal (IEC Standard)
Power supply	5.5HP (4KW), 380 V / 2 Poles / 3 Phase / 50 Hz , Protection IP 55 , Insulation class F
Output speed	2900 rpm. ( Approx. )
Mounting flange	SUS 304
U - Joint coupling	Forged carbon steel
Hollow shaft	SUS 304
Housing	SUS 304
Sleeve	Ceramic
Propeller	SUS 304
Diffuser	SUS 304
Bearing	Solid rubber
Float	U – shape made of polyethylene and within polyurethane foam
Oxygentransfer rate	0.8 – 1.5 kg. O <sub>2</sub> / Hp / Hr at standard condition